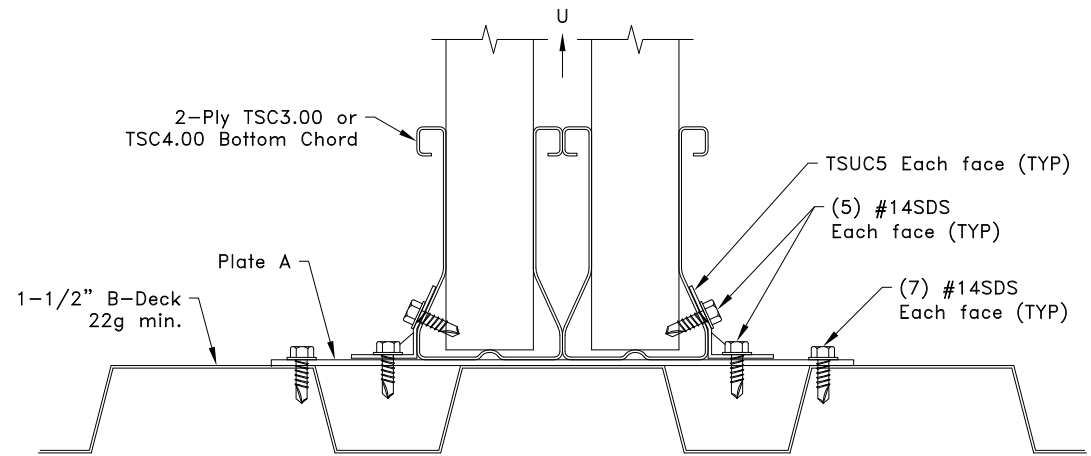

Plate A
12g ASTM A653 SS Grade 33 G60
Bare Metal Thickness: $t = 0.0966"$



U = 1100#

General Notes:

1. SDS = Self-Drilling Tapping Screw
2. Screw end distance and edge distance is $3/8"$ minimum. Screw spacing is $3/4"$ minimum.
3. U refers to uplift.
4. Cold-Formed Steel Calculations are per the 2010 addendum to the AISI 2007 "North American Specifications for the Design of Cold-Formed Steel Structural Members" (S100-07/S2-10).

TrusSteel®

www.TrusSteel.com

Florida: 2400 Lake Orange Drive, Suite 150 / Orlando, FL 32837 / (800) 755-6001
Missouri: 13389 Lakefront Drive / Earth City, MO 63045 / (800) 326-4102

**Truss Connection To Metal
Decking**

ITW Building Components Group, Inc. shall not be responsible for any performance failure in a connection due to a deviation from this detail. Any variation from this detail shall be approved in advance by ITW Building Components Group, Inc.

Custom Detail:

CD141102

Date:

11/05/14

Custom Detail Category:

Truss-To-Bearing Connection